



PRODUCT:

**BREATHING AIR FILTRATION PANEL
ACCESSORIES**

PART NUMBER:

**9871-02 (REMOTE CO MONITOR)
9871-03 (POINT OF ATTACHMENT)
9900-45 (BREATHING AIR PUMP CO MONITOR)**

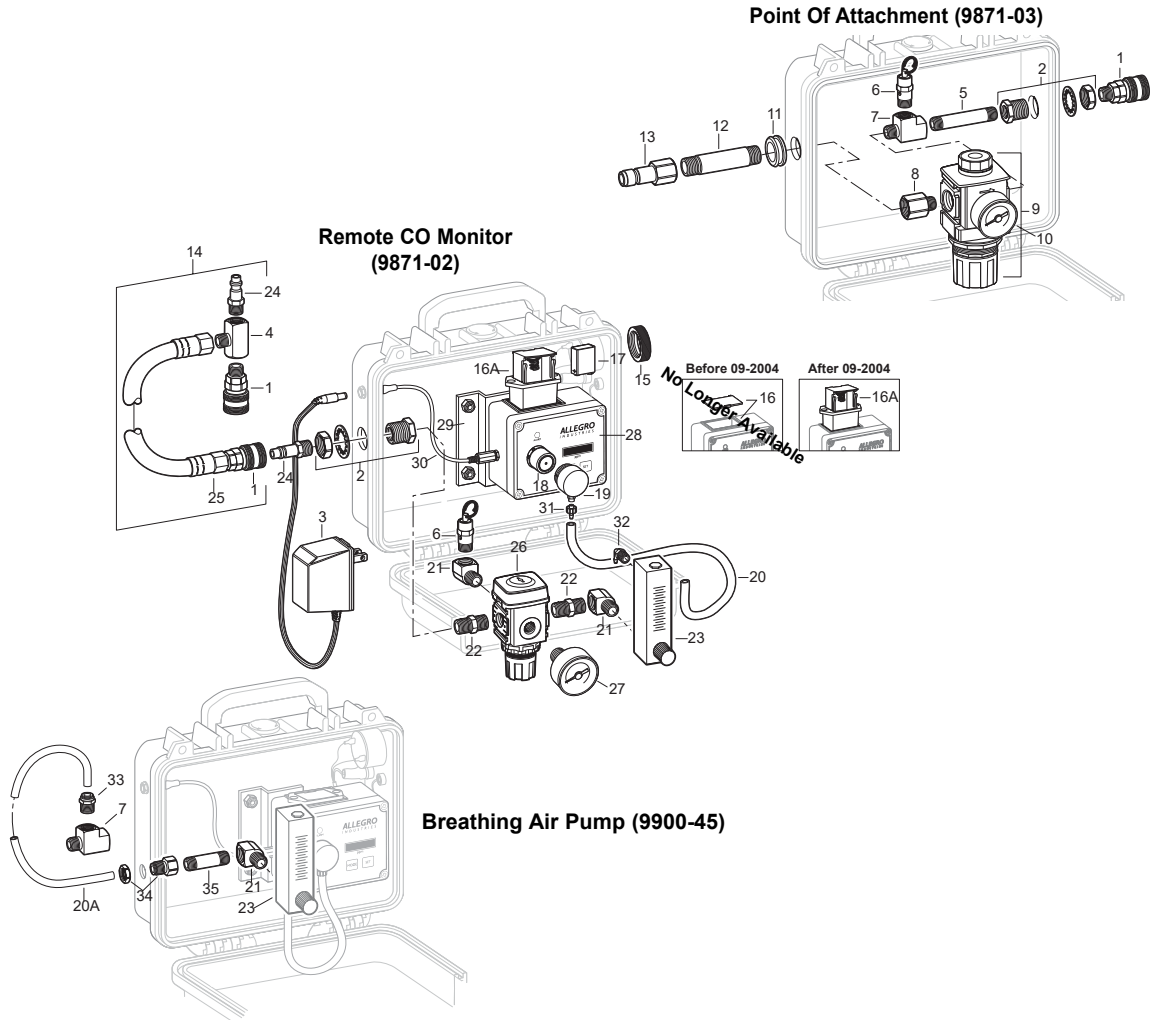

KEY	PART #	DESCRIPTION	KEY	PART #	DESCRIPTION	KEY	PART #	DESCRIPTION
	9871-02	Remote CO Monitor	14	9871-02PT	CO Sample Line Pigtail Assembly	23	9872-25	Flow Meter
	9871-03	Point of Attachment	15	9871-20	Alarm Bezel Nut	24	8400-04A	Plug
	9900-45	Breathing Air Pump CO Monitor	16	9872-91	Battery Compartment Cover (Not sold separately) NO LONGER AVAIL.	25	9872-43	6 foot Hose (w/o Coupler)
1		Coupler (See Coupler Page)	16a	9872-91A	Battery Compartment (Purchased before 09-2004) NO LONGER AVAIL.	26	9872-06	Mini Regulator
2	9872-11	Bulkhead		9872-91A	Battery Compartment (Purchased after 09-2004)	27	9872-08	Gauge
3	9872-95	AC to DC Power Supply	17	9871-01F	Alkaline Battery (9 volt)	28	9872-02BC	CO Monitor (Includes #16-19)
4	9875-23	Branch Tee	18	9872-69	CO Sensor		9872-02	CO Monitor AC/DC (9900-45)
5	9871-04F	Nipple (Brass)	19	9872-69R	Sensor CO Monitor w/Roto Switch	29	9865-17	CO Monitor Bracket
6	9875-09	Relief Valve (125 psi)	19a	9872-92	CO Sensor Cover	30	9872-88	DC Cable Extension
7	9872-27	Street Tee		9872-14C	White Female Plastic Luer (single replacement piece only)	31	9872-14B	Male Luer
8	9872-44	Reducer (Brass)	20	9872-14	Poly Tubing	32	9872-17	Elbow
9	9875-06	Regulator (w/ Gauge)	20a	9872-14A	Poly Tubing (9900-45)	33	9900-46	Push Connector, Male
10	9875-08	Gauge	21	9872-18	Adapter	34	9900-47	Push Connector, Bulkhead Fit
11	9875-12	Grommet	22	9000-25	Nipple (Brass)	35	9872-24	Nipple (Brass)
12	9875-21	Large Brass Nipple (LP)						
13	9700-72C	Plug						
	9700-73B	Plug, OBAC						