

## SPECIFICATIONS

Product Description: **BLOWER**  
 Part Number: **9518-03S, 9518-03, 9518-06, 9518-08, 9518-10**  
 Style: **METAL VENTURI**

### GENERAL DESCRIPTION:

The Venturi Blowers are a perfect solution to moving air in refineries, utility and power plants, shipyards, paper and pulp plants, the marine and steel industry and manhole operations. Anywhere where fumes may be poisonous, explosive, or hazardous from process towers, tanks, large pipes or confined space need to be removed. You can cool workers in elevated temperature conditions, or heavy equipment. Our line of high-performance, lightweight Venturi Blowers helps create a safe, healthy working environment leading to greater efficiency and productivity. Welding fumes, hot air, gases, and smoke can all be removed quickly and easily.



### CONSTRUCTION:

- Lightweight Galvanized steel
- 6' (1.8 m) static ground connection attached to the inlet housing (for use in hazardous locations)
- Cast aluminum base
- Plastic Handle
- 1 to 1 ½" hose with "crows' foot" connection recommended
- Does not require protective grills

### DUCT CONSTRUCTION: (Optional)

- Single ply PVC coated vinyl and polyester materials
- Temperature resistant up to 180° F
- Retractable, non-collapsible design
- Class 1 hard drawn spring steel wire helix
- Meets ASTM 227
- Yellow color with black wearstrip

Blower Dimensions								Air Flow								
Part No	Overall Length (A)	Base Diameter (B)	Diameter Top of Horn (C)	Thread (NPT) (D)	Bolt Circle Diameter (E)	Basic Slot Diameter (F)	Net Weight (lb.)	AIR CONSUMED (SCFM)			TOTAL AIR FLOW (CFM)			STATIC PRESSURE (IWC)		
								60 PSIG	80 PSIG	100 PSIG	60 PSIG	80 PSIG	100 PSIG	60 PSIG	80 PSIG	100 PSIG
<b>9518-03S</b>	16.75"	7.31"	6.00"	1/2"	6.56"	0.4" *	5.5	30	40	50	865	1080	1205	5.8	7.5	8.8
<b>9518-03</b>	30.50"	7.31"	7.00"	1/2"	6.56"	0.4" *	8.5	30	40	50	1135	1310	1465	5.8	7.5	8.8
<b>9518-06</b>	44.25"	11.25"	12.50"	1"	10.50"	0.4" *	22.3	60	80	100	2560	3020	3700	4.2	5.6	6.5
<b>9518-08</b>	46.06"	14.37"	14.25"	1"	13.62"	0.5" *	36.0	110	140	180	4215	4810	5435	4.0	5.2	6.2
<b>9518-10</b>	48.00"	17.50"	15.75"	1"	15.50"	0.6" **	42.0	190	250	380	6180	7305	8220	5.5	6.7	7.7

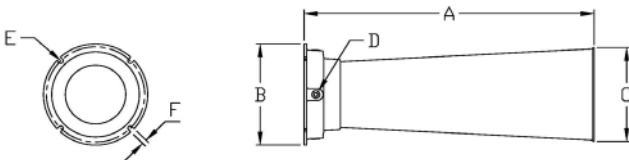

\* 3 MOUNTING SLOTS  
 \*\* 4 MOUNTING SLOTS

Free Air Induction Rates				Decibels (@ 5 ft.)		
Part No	60 PSIG	80 PSIG	100 PSIG	60 PSIG	80 PSIG	100 PSIG
<b>9518-03S</b>	28.83	27.00	24.10	66	68	71
<b>9518-03</b>	37.83	32.75	29.30	69	72	73
<b>9518-06</b>	42.67	37.75	37.00	73	75	78
<b>9518-08</b>	38.32	34.36	30.19	77	79	81
<b>9518-10</b>	32.53	29.22	21.63	81	83	85