



## SPECIFICATIONS

Product Description:  
Part Number:  
Style:

**8" (20.3 cm) AXIAL EXPLOSION-PROOF PLASTIC BLOWER (220V/50 Hz)**  
**9538-E, 9538-15E, 9538-25E, 9538-50E**  
**WITH OR WITHOUT CANISTER**

### GENERAL DESCRIPTION:

High output from a compact axial blower, designed for easy use and storage without sacrificing airflow. Available as blower only or complete unit with 15' (4.57 m), 25' (7.62 m) or 50' (15.2 m) of statically conductive ducting and storage canister. Canister attaches to intake or output sides of blower for suction or ventilation. It is designed for hazardous locations.

### CONSTRUCTION:

- New compact canister in 9538-15E and 9538-25E models is the lightest and smallest in the industry!
- Polyethylene housing and canister assembly
- Lightweight, corrosion-, UV- and chemical-resistant
- Super quiet, "safety orange"
- Bottom enclosure to protect electrical components
- Carry handle molded into blower and canister housing
- Steel powder coated grill
- *NOTE: EX blowers require an explosion-proof socket (PN 9503-06)*

### MOTOR:

HP: 1/3 HP  
Certifications: UL Listed, CSA Certified  
Voltage/Hz: 220V AC, 50 Hz, Single Phase  
Max RPM: 2750 (loaded at 220V, 50Hz)  
Current Draw: 1.2A (loaded at 220V, 50Hz)  
Cord: 25' SJOOW 18/3 AWG 300V, medium duty

### FAN:

- PAGAS (Anti-static glass reinforced Polyamide) six blade fan
- Aluminum hub

### DUCTING: (included on 9538-15E, 9538-25E and 9538-50 models)

- Black single-ply lightweight vinyl/polyester, coated with neoprene 250° F (121.1° C) temp. resistant
- Non-collapsible retractable design, Class 1 hard drawn spring steel wire helix
- *WARNING: When using statically conductive ducting, the integrated grounding wire must be properly grounded to the blower chassis OR linked to any additional grounding wire or duct used (as shown). Refer to User Manual for detailed instructions.*

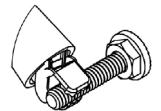

### HAZARDOUS LOCATION RATINGS:

Class: I	Class: II
Divisions: 1 & 2	Division: 1 & 2
Groups: C & D	Groups: F & G

### BLOWER DIMENSIONS:

Blower P/N	Length	Width	Height	Weight
9538-E	13 1/4" (33.6 cm)	12" (30.4 cm)	13 3/4" (34.9 cm)	17 lbs. (7.7 kg)
9538-15E	26" (66.0 cm)	13 1/2" (34.2 cm)	14 1/2" (36.8 cm)	25 lbs. (11.3 kg)
9538-25E	26" (66.0 cm)	13 1/2" (34.2 cm)	14 1/2" (36.8 cm)	30 lbs. (13.6 kg)
9538-50E	32" (81.3 cm)	13 1/2" (34.2 cm)	14 1/2" (36.8 cm)	40 lbs. (18.1 kg)

### \*FLOW RATES: (CFM calculated using 15' (4.57 m) of 8" (20.3 cm) ducting)

Free Air	One 90° Bend	Two 90° Bends
900 CFM (1529.1 m³/hr)	650 CFM (1104.35 m³/hr)	625 CFM (1061.8 m³/hr)

\*Air flow determined at 60Hz



9538-E (Blower Only), 9538-15E, 9538-25E



9538-50E