



SPECIFICATIONS

Product Description: **VENTILATION BLOWER, HIGH OUTPUT, EXPLOSION-PROOF**
Part Number: **9525-50EX**
Style: **AXIAL FAN 20" (50.8 cm)**

GENERAL DESCRIPTION:

Designed for applications requiring a maximum amount of output. Made from 16-gauge cold rolled steel housing and powder-coated in safety orange with 3 blade impeller. Powered by a 1 ½ hp, 3450 RPM UL listed, IECEX/ATEX/INMETRO certified motor. Comes with an interchangeable flange for intake or exhaust mounting, integrated carry handles for easy transport and a steel/zinc plated grill. Four rubber feet, built in on/off switch and voltage change switch are added features of this powerhouse unit.



CONSTRUCTION:

- Complete unit epoxy powder-coated in orange
- Interchangeable flange for intake or exhaust side mounting
- 16-gauge cold rolled steel housing
- Integrated carry handles
- Steel grill (zinc plated), equipped with four rubber feet
- Built-in "on/off" switch
- Duct grounding lug
- *NOTE: EX blowers require an explosion-proof socket (110V PN: 9503-03, 220V PN: 9503-06)*

MOTOR:

HP: 1 ½ HP
Certifications: UL Listed, IECEX/ATEX/INMETRO Certified
Voltage/Hz: 115/230V AC, 50/60 Hz, Single Phase (Integrated voltage selector)
RPM: 3450
Current Draw: 15.5/7.8A (60 Hz)
Cord: 25' (7.63 m) 12/3 AWG MTW 90C 600V
Plug: NEMA 20 Amp, 115V or 200V plug, Explosion Proof rated
Protection: Thermal, Automatic Reset

FAN:

- Anti-Static glass reinforced polyamide (PAGAS) three blade fan with aluminum hub

ACCESSORIES:

Ducting

- Black, single-ply, neoprene coated, statically conductive vinyl/polyester material, temp. resistant up to 250° F (121.1° C)
- Retractable, non-collapsible design, Class 1 hard drawn spring steel wire helix (meets ASTM 227 specs)
- Grounding cable on both ends
- *WARNING: When using statically conductive ducting, the integrated grounding wire must be properly grounded to the blower chassis OR linked to any additional grounding wire or duct used (as shown). Refer to User Manual for detailed instructions.*

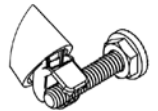

EX Rated Receptacle

- Iron mounting box with triple coat finish and spring-loaded door to keep out dust when in use. When plug is not in use, a neoprene gasket inside receptacle seals around plug to keep out dirt, water, dust, etc.
 - 9503-03: 125V only
 - 9503-06: 250V only

EX Rated Extension Cords

- 9540-50EX: 115V
- 9540-60EX: 230V

Continued on Page 2

HAZARDOUS LOCATION RATING:*Motors**EX Plugs*

| | | | |
|---------|----------------|---------|---|
| ATEX | II 2 G Ex d Gb | NEC 500 | Class I, Group B, C, D Class II, Group F&G |
| IECEX | Ex d IIB Gb | NEC 505 | Class I, Zone 1, Group IIB & H2 |
| INMETRO | Ex d IIB Gb | | |

BLOWER DIMENSIONS:

| Length | Width | Height | Weight |
|---------------|---------------|-----------------|-------------------|
| 19" (48.2 cm) | 22" (55.8 cm) | 22 ½" (57.1 cm) | 71 lbs. (32.2 kg) |

***FLOW RATES:** (CFM calculated using 15' (4.57 m) of 20" (50.8 cm) ducting)

| Free Air | One 90° Bend | Two 90° Bends |
|--|---------------------------------------|---------------------------------------|
| 6837 CFM (11622.90 m ³ /hr) | 5268 CFM (8950.38 m ³ /hr) | 4829 CFM (8209.30 m ³ /hr) |

**Air flow determined at 60Hz*