



SPECIFICATIONS

Product Description: **BLOWER**
 Part Number: **9518-13S, 9518-13, 9518-16, 9518-18**
 Style: **PLASTIC VENTURI**

GENERAL DESCRIPTION:

The Plastic Venturi Blower is a perfect solution to moving air in refineries, utility and power plants, shipyards, paper and pulp plants, the marine and steel industry and manholes. Anywhere where fumes may be poisonous, explosive or hazardous from process towers, tanks, large pipes or confined space need to be removed. Can be used to cool workers in elevated temperature conditions or heavy equipment. Our Plastic Venturi Blowers help to create a safe, healthy working environment leading to greater efficiency and productivity. Welding fumes, hot air, gases and smoke can all be removed quickly and easily.

CONSTRUCTION:

- Lightweight, rugged, dent-proof, corrosion-resistant, anti-static, conductive cone made of Linear Low Density Polyethylene (LLDPE) recyclable plastic
- Casted aluminum inlet housing
- Multiple inlet ports
- Static ground connection attached to the inlet housing (for use in hazardous locations)
- 1 to 1 1/2" hose with "crows foot" connection recommended
- Maximum operating temperature of 220° F



DUCTING: (Optional)

- Retractable, non-collapsible design
- Single-ply, PVC coated, vinyl and polyester materials, temperature resistant up to 180° F
- Yellow color with black weather-strip and integrated nylon straps
- Class 1 hard drawn spring steel wire helix that meets ASTM 227 specs

STATICALLY CONDUCTIVE DUCTING: (Optional)

- Black, single-ply lightweight vinyl/polyester, neoprene coated, heat resistant up to 250° F
- Retractable, non-collapsible design, Class 1 hard drawn spring steel wire helix (meets ASTM 227 spec)

| Part No. | Blower Dimensions | | | | | | | Air Flow | | | | | |
|-----------------|--------------------|-------------------|--------------------------|------------------|--------------------------|-------------------------|------------------|---------------------|---------|----------|----------------------|---------|----------|
| | Overall Length (A) | Base Diameter (B) | Diameter Top of Horn (C) | Thread (NPT) (D) | Bolt Circle Diameter (E) | Basic Slot Diameter (F) | Net Weight (lb.) | AIR CONSUMED (SCFM) | | | TOTAL AIR FLOW (CFM) | | |
| | | | | | | | | 60 PSIG | 80 PSIG | 100 PSIG | 60 PSIG | 80 PSIG | 100 PSIG |
| 9518-13S | 16.75" | 7.31" | 7.00" | 1/2" | 6.56" | 0.4" * | 4.4 | 30 | 40 | 50 | 865 | 1080 | 1205 |
| 9518-13 | 31.50" | 7.31" | 7.37" | 1/2" | 6.56" | 0.4" * | 6.2 | 30 | 40 | 50 | 1135 | 1310 | 1465 |
| 9518-16 | 44.25" | 11.25" | 12.50" | 1" | 10.50" | 0.4" * | 14.9 | 60 | 80 | 100 | 2560 | 3020 | 3700 |
| 9518-18 | 46.00" | 14.35" | 15.37" | 1" | 13.62" | 0.5" * | 23.3 | 110 | 140 | 180 | 4215 | 4810 | 5435 |

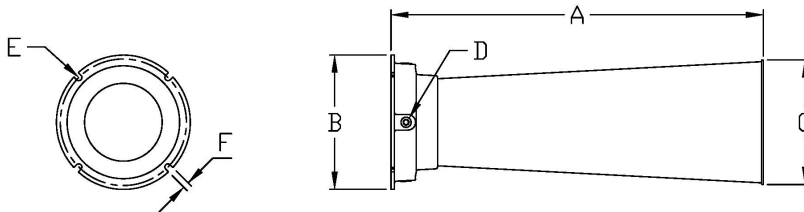

* 3 MOUNTING SLOTS
 ** 4 MOUNTING SLOTS

| Free Air Induction Rates | | | |
|--------------------------|---------|---------|----------|
| Part No | 60 PSIG | 80 PSIG | 100 PSIG |
| 9518-13S | 28.83 | 27.00 | 24.10 |
| 9518-13 | 37.83 | 32.75 | 29.30 |
| 9518-16 | 42.67 | 37.75 | 37.00 |
| 9518-18 | 38.32 | 34.36 | 30.19 |